

BC100 Bluetooth Accedd Control Moudel User Manual

I:Size

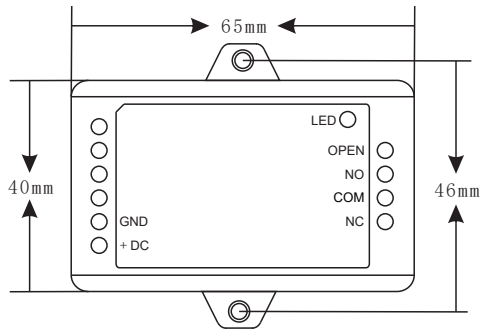

II:Product Instruction

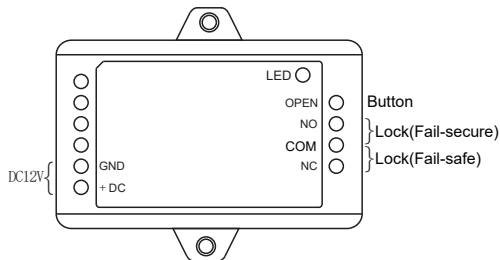

III: Button wiring diagram

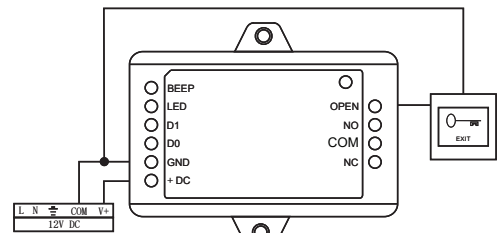

Bluetooth model to connection access controller

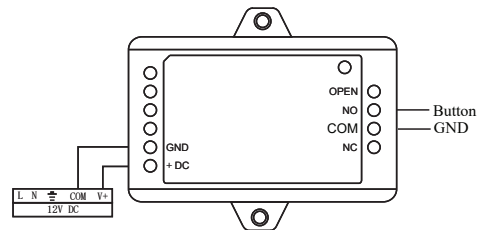

IV:Lock wiring diagram

1.Module and lock use the same power

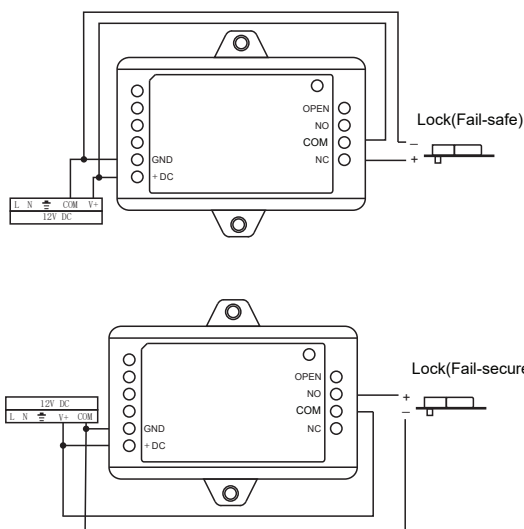

2.Module and lock use the difference power

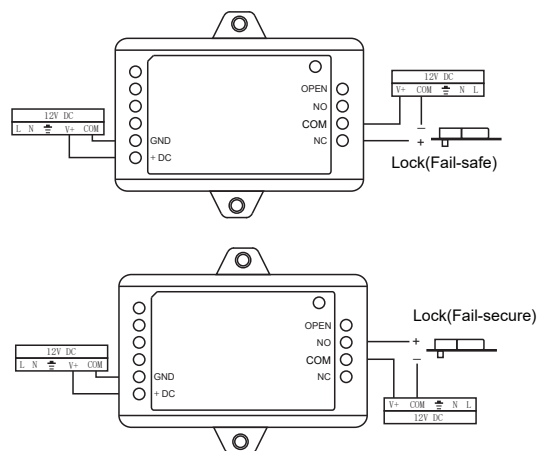



Disclaimer:

As equipment and software are continuously upgraded and optimized, we will continue to optimize products and software on the premise of ensuring the basic functions of products and software to improve customer experience, and we will not assume any subsequent responsibilities.



Hallokey

Hallokey APP Quick Guide

Make All Freely

1. Download and install the "Hallokey" mobile APP software.

1. Scan the IOS QR code on your iPhone, or search for "Hallokey" APP in the app store, download and install it.

2. Scan the Android QR code on your Android phone, or search for "Hallokey" APP in the Google App Market, download and install it.

If it is not the latest version, the system will prompt you to upgrade to the latest version after installation. Please upgrade in time.



IOS



Android

ENTERPRISE-GRADE
ACCESS MANAGEMENT CONTROL SYSTEMS
Make All Freely

2. Register and log in to Hallokey account.

1. Open the Hallokey APP software on your phone, and follow the instructions on your phone to register step by step.

2. Follow the APP operation prompt, enter your email and password to log in, if you are not active, click to log out, Then the software will automatically log in next time you start the software, otherwise you need to log in again.

Login



Please enter phone number / email

Please enter the password

Login

Register

Forget password?

< Email registration



Please enter your email account

Please enter verification code [Get code](#)

Next step

Phone number registration

3. Management devices in web software

You can Management devices in web software or in hallokey APP.

Web address:

<https://web.hallokey.com:90/#/login>

3.1.Register & Login web serve to add Your Community



☒ Auto login [Register an account](#)

3.2.Add Your Community

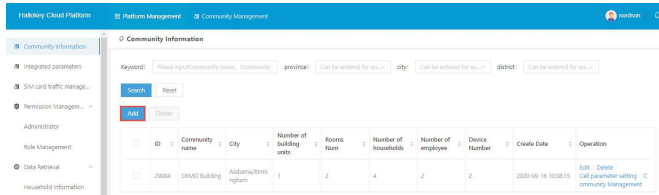

Community Information

Keyword: Please input Community name, Community province: Can be entered for qz... city: Can be entered for qz... district: Can be entered for qz...

ID	Community name	City	Number of building units	Rooms Num	Number of households	Number of employee	Device Number	Create Date	Operation
29084	DEMO Building	Alabama/Birmingham	1	2	4	2	2	2020-09-16 10:08:15	Edit Delete Call parameter setting Community Management

3.3.Click to enter the community management page

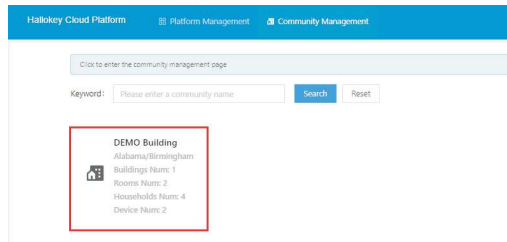

Click to enter the community management page

Keyword: Please enter a community name

DEMO Building
Alabama/Birmingham
Buildings Num: 1
Rooms Num: 2
Households Num: 4
Device Num: 2

3.4.Add the APP user for employee

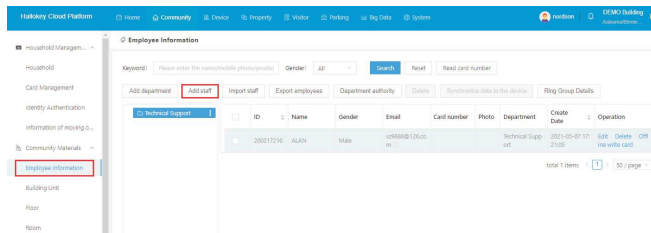

Employee Information

Keyword: Please enter the name/mobile phone/position Gender: All

ID	Name	Gender	Email	Card number	Photo	Department	Create Date	Operation
200217216	ALAN	Male	st5066@126.com			Technical Support	2021-05-07 17:21:05	Edit Delete Offline write card

total 1 items 1 / 30 / page

3.5. Add the APP user for employee

Add staff



Browse Capture Read ID card

* Name:

* Department:

Email:

If the resident uses the APP, please fill in the email account of the resident registration APP

Job number:

Position:

ID type:

ID number:

Card Management

+ Add card number

You can add RFID card by here

- Support multiple cards for one person
- Get card number from card reader: Click the Add card number button, and then put the physical card on the card reader device, it will automatically get the card number into the text box
- Reminder: If there is an offline device, please save the personnel information before performing the offline card writing operation in the list

Fingerprint Management

+ Add Fingerprint

Access authority

Disable access control: ☐

Valid period: Start Time End Time

After setting the validity period of access control, it can be used normally in this period of time, and the time and card issuing need to be modified after expiration

Push permissions

Abnormal temperature alarm: ☐

3.6. Door Management

Household Management

Door Management

Please select: Position type name: Binding device:

ID	Door name	Location	Position type name	Binding device	Create Date	Operation
482762	4G	DEMO building	Community door		2021-05-10 15:00:06	<input type="button" value="Edit"/> <input type="button" value="Delete"/>
482116	RD	DEMO building	Community door	102976294	2021-05-08 11:53:08	<input type="button" value="Edit"/> <input type="button" value="Delete"/>
411802	Door1	DEMO building/Test building	Unit door	101879434	2021-01-08 11:54:01	<input type="button" value="Edit"/> <input type="button" value="Delete"/>

total 3 items / 50 / page

3.7. Add device in Cloud Platform

Household Management

Device Management

Device

Keywords: Device category: Device model: Status:

power: Version: SIM Card number:

ID	Name	Serial number	Category	Device model	Installation location	Operation
223030	GD40	10200762334	Access control machine	BC240	RD	<input type="button" value="Edit"/> <input type="button" value="Delete"/> <input type="button" value="Device param"/>
201802	BC200	1016194144	Access control machine	BC200	Test Building/Door1	<input type="button" value="Edit"/> <input type="button" value="Delete"/> <input type="button" value="Device param"/>

total 2 items / 50 / page

4. APP management devices

***Note: Only community employees have this permission.**

(Members of households no permission to add equipment)

Please set APP user for the employee in web software(**Please refer to instruction 3.4**).

APP Steps: Devices>Add Device

*Input Installation Position>*Device Name>*Device SN

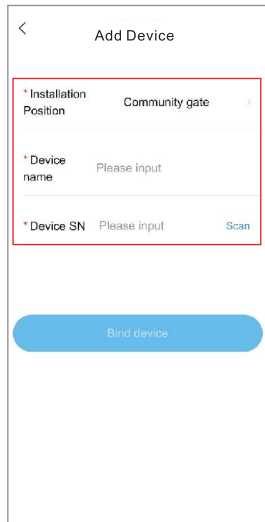
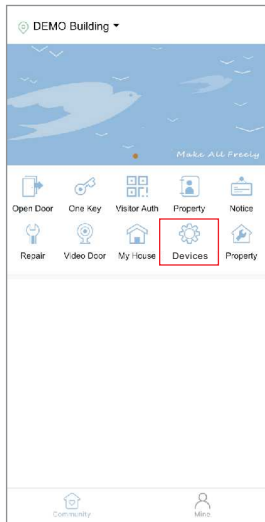

5. Configure WIFI communication parameters.

Steps: Devices>Device>Configure Params

Add the correct WIFI name and password. After the pairing is successful, the LED is always on.

The specific operation is shown in the figure below: the specific operation is shown in the figure below:

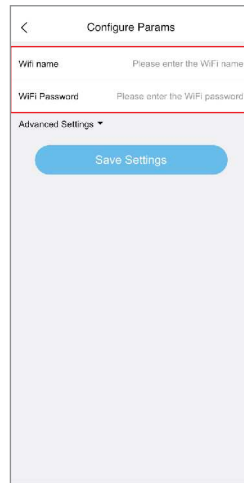
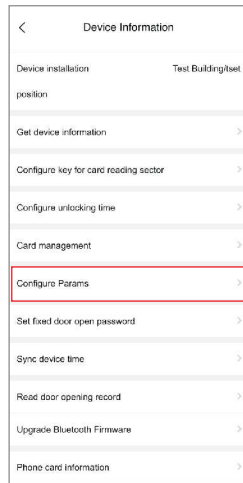

6. Set a fixed password to open the door.

Steps: Devices>Device Information>Set Fixed Door Open Password
Please follow the menu prompts to set a fixed password to open the door. If this password is not changed, it will be permanently effective. The specific operation is shown in the figure below:

The figure consists of two screenshots from a mobile application. The first screenshot shows the 'Device Information' screen with a list of settings. The 'Set fixed door open password' option is highlighted with a red box. The second screenshot shows the 'Device emergency password' screen. It contains a tip: 'Tip: If you have not set a password, the old password does not need to be filled in, and the device password is six digits'. Below the tip are two input fields: 'Old password' with the placeholder 'Please enter an old password' and 'New password' with the placeholder 'Please enter a new password'. Both fields are highlighted with a red box. At the bottom of the screen is a blue 'Save Settings' button.

7. Set the unlock delay.

Steps: Devices>Device Information>Configure Unlocking Time
The unlocking delay time can be set to 1-254S (the delay time supported by different devices will be different)
The specific operation is shown in the figure below:

The figure consists of two screenshots from a mobile application. The first screenshot shows the 'Device Information' screen with a list of settings. The 'Configure unlocking time' option is highlighted with a red box. The second screenshot shows the 'Configure unlocking time' screen. It has two sections: 'Electric Lock Control' with a checkmark and 'Manual Control'. Below these is a setting for 'Unlock time(1-254s)' with a value of '5', which is highlighted with a red box. At the bottom of the screen is a blue 'Save Settings' button.

8. Temporary user management.

Step: Visitor Authorization

Please follow the menu prompts and press the house or device authorization to generate a temporary visitor password or QR code.

The specific operation is shown in the figure below: the specific operation is shown in the figure below:

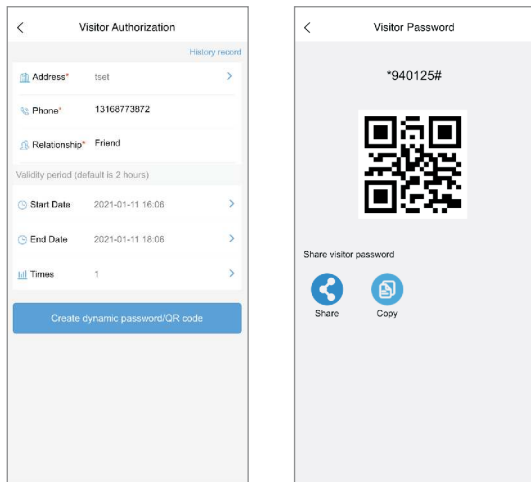

9. The phone opens the door.

Step: Open Door or One Key

Open Door can choose two modes of remote WIFI door opening and Bluetooth door opening.

WIFI remote open the door, you can open the door lock of the area where the device is located across areas.

Bluetooth door open, you can open the default door lock in the Bluetooth communication area.

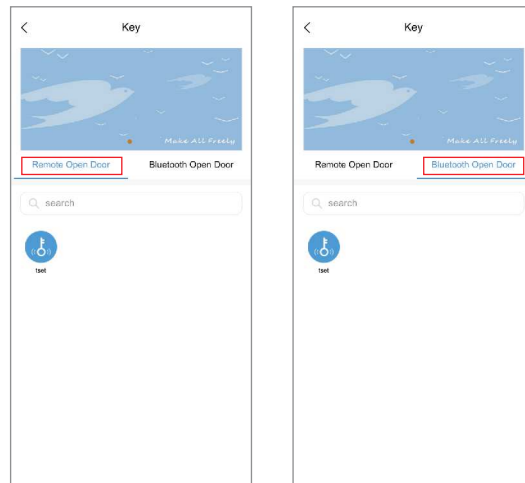

10. User management.

Step: My house>Room Member>Add Members

Members Please follow the menu prompts, you can add users with Owner, Family and Tenant identities.

The specific operation is shown in the figure below:

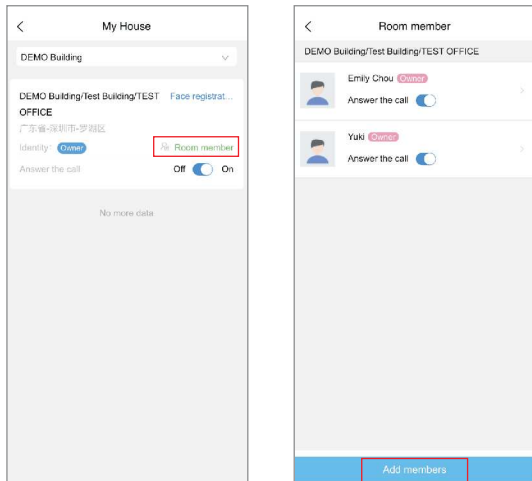

11. Card management.(The function only for Bc200 device)

Step: Devices>Device Information>Card Management

Please add or delete the access card according to the menu.

*Common menu:Swipe to Add Card Number can add access control cards in batches;

Swipe to Deelete Card Number can Deelete access control cards in batches.

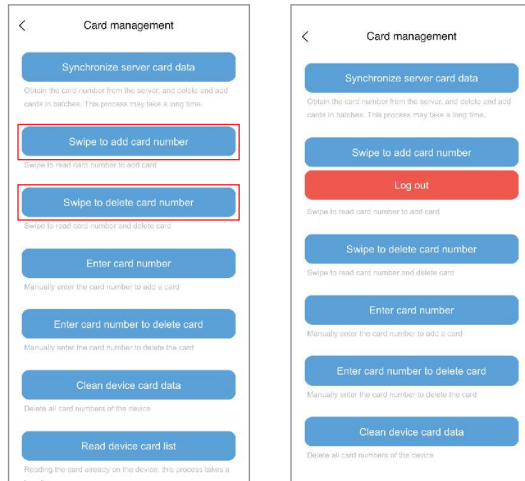

12. Door opening mode, door opening distance, door opening delay setting and door opening distance Mine.

1.Step:Mine>Open the door near the field

Close to open the door: you can set close proximity to automatically open the door(This function cannot guarantee that every brand of mobile phone can be applied)

2.Step:Mine>Open the door near the field>Sensing distance

This function can adjust the Bluetooth sensing distance. About < 30meters

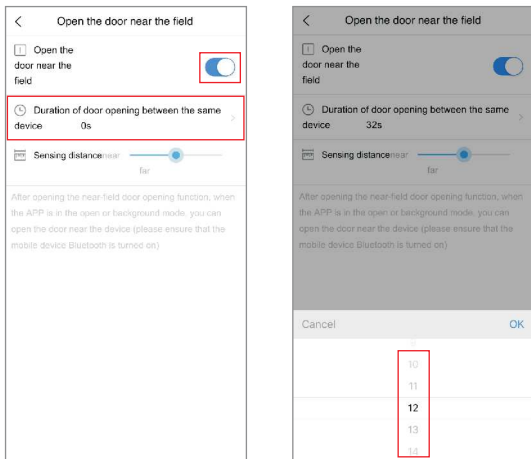

13. Door opening record.

1. View the door opening record. Step Mine>Open records

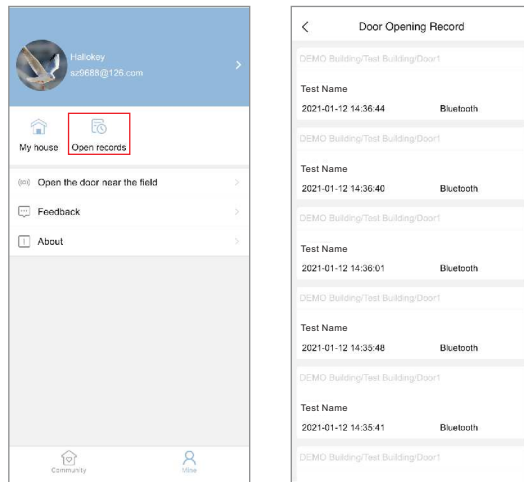

14. Repair.

.Step:Repair.

You can report the device or the event you need service to the administrator here.

A mobile app screenshot of the 'Repair' form. The title bar shows a back arrow and the word 'Repair'. Below the title bar are two tabs: 'Repair' (highlighted with a red box) and 'Repair List'. The form contains several input fields: 'Phone' with placeholder text 'Please enter phone number', 'Type' with placeholder text 'Please select repair type' and a right arrow, 'Address' with placeholder text 'Please select a repair address' and a right arrow, and 'Time' with placeholder text 'Please select an appointment' and a right arrow. Below these fields is a text area with placeholder text 'Please enter repair content: (max: 400 words)'. At the bottom is a section labeled 'Upload photos' with a camera icon and a 'Submit' button.

A mobile app screenshot of the 'Repair List' form. The title bar shows a back arrow and the word 'Repair'. Below the title bar are two tabs: 'Repair' and 'Repair List' (highlighted with a red box). The form displays a repair order with the following details: 'Repair order ID 20210112230302', 'Pending' status, 'Type: water & gas', 'Address: DEMO Building/Test Building/TEST OFFICE', and 'Create time 2021-01-12 23:03:03'. There is a 'Revoke' button next to the create time.

15. Notice.

Step:Notice. You can view the announcement information issued by the administrator here.

A mobile app screenshot of the 'Community Announcement' screen. The title bar shows a back arrow and the text 'Community Announcement'. Below the title bar is a blue banner with a megaphone icon and the text 'Reminder: Click to view details'. Below the banner is a white card with the title 'Notice' and the content 'Notice Test'. At the bottom right of the card is the timestamp '2021-01-12 23:00:40'.

Hallokey Cloud Platform 3.0.2

Operation Guide

V3.0.2

Version update history

Version	Update date	Update content	Modified by
V3.0.1	2020.12.26	Hallokey Cloud Platform 3.0 Operation Guide	Jason
V3.0.2	2021.1.6	9. Add guest temporary password and 10. Call intercom	Jason

Hallokey Cloud Platform 3.0	Operation Guide.....	1
Must read before operation.....		2
Access domain.....		2
Specification of operation.....		2
Operation flow chart.....		3
1.Login.....		3
1.1Login.....		3
2.Administrator rights management.....		4
2.1 Administrator privilege operation.....		4
2.2.Role management.....		5
2.2.1 Add role management.....		5
3.Community management.....		6
3.1 Add Community.....		6
3.2 Community parameter configuration.....		6
3.3 Switch community.....		8
4.Building unit management.....		10
4.1Building Unit.....		10
5.House management.....		11

5.1 House management.....	11
6.Door management.....	11
6.1 Door.....	12
6.1.1 Add community gate.....	12
6.1.2 Add unit door.....	12
6.1.3 Add room door.....	13
7. Community.....	13
7.1 Household Management.....	13
7.1.1 Add households.....	13
7.1.2 Offline card issue operation.....	14
7.2 Card management.....	15
8.Device.....	15
8.1 Device management.....	15
8.1.1 Add device.....	15
9.Visitors password.....	16
9.1 Visitors password.....	16
9.1.1Visitors password.....	16
10.Call intercom.....	17
10.1 Access control call indoor device.....	17

➤ Must read before operation

● Access domain

Access domain: <https://web.hallokey.com:90/#/login>

● Specification of operation

Note: Each community is managed independently, and the community can be operated independently by switching communities.

1. Red asterisk (*) is required.
2. All query operations are only shown on the page, such as keywords, status, card reader operation, etc.
3. Please be cautious when delete in batches on the pages
4. All delete operations are the same, click the delete button, and pop up a dialog box and select [Cancel] or [Confirm], without mentioning the document example.
5. Most of the editing and adding are the same. The editing operation does not mention document examples.
6. Basic standard operation process: such as creating a community-> building unit-> houset-> door-> device<—> household, etc.

● Operation flow chart

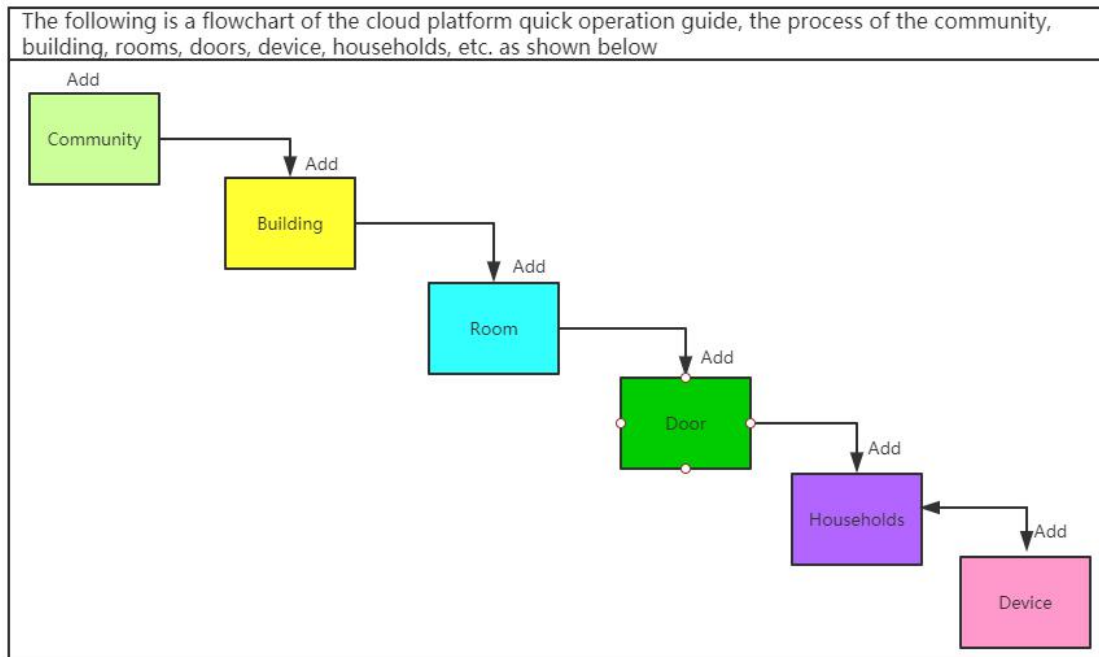

1. Login

1.1 Login

Enter the user name, user password, verification code, etc. on the login page correctly, and click the [Login] button.

Description: Check to enable the auto login, browser will remember personal account information for 7 days

A screenshot of the login page for the Hallokey system. The page has a light blue background. It contains a login form with the following elements: a text input field for the username with the placeholder 'nordson'; a text input field for the password with the placeholder '请输入用户密码'; a text input field for the verification code with the placeholder '请输入验证码' and a small image of a verification code; a checkbox labeled '自动登录' (Auto login) which is checked; and a blue button labeled '登录' (Login).

2.Administrator rights management

2.1 Administrator privilege operation

2.1.1 Add super administrator rights

Click [Add], fill in the relevant information of the administrator, select [Super administrator], click [Submit]

Description: Role Super Administrator: (Has all permissions)

The screenshot shows the 'New Administrator' dialog box in the IoT Platform. The dialog has the following fields and options:

- Username:** Text input field.
- Real Name:** Text input field.
- Email:** Text input field.
- Password:** Text input field with a hint: 'The default password is 123456'.
- Second Password:** Text input field.
- Character:** Radio button selection with three options:
 - ☒ Super Administrator: Has all permissions.
 - ☐ Community Administrator: Has all permissions for community management.
 - ☐ Custom Character: Custom community management rights.
- Status:** Radio button selection with two options:
 - ☒ Normal.
 - ☐ Forbidden.

At the bottom of the dialog are 'Submit' and 'Cancel' buttons. The 'Submit' button is highlighted with a red box. In the background, a table of administrators is visible, with the 'Add' button highlighted by a red box.

2.1.2 Add community administrator permissions

Click [Add], fill in the relevant information of the administrator, select [Community Administrator], select [Management Community] to select multiple, and click [Submit].

Description: Community administrator (has all rights of community management)

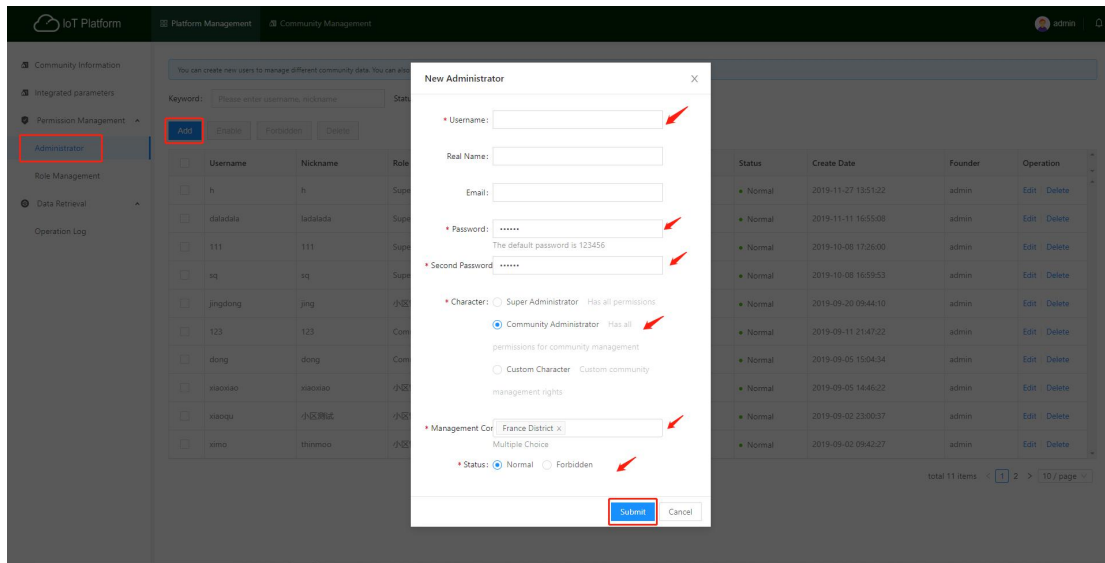

2.1.3 Add custom role management permissions

Click [Add], fill in the relevant information of the administrator, select [Custom Role], select [Management Community] to select multiple, and click [Submit].

Description: Custom roles (custom community management permissions)

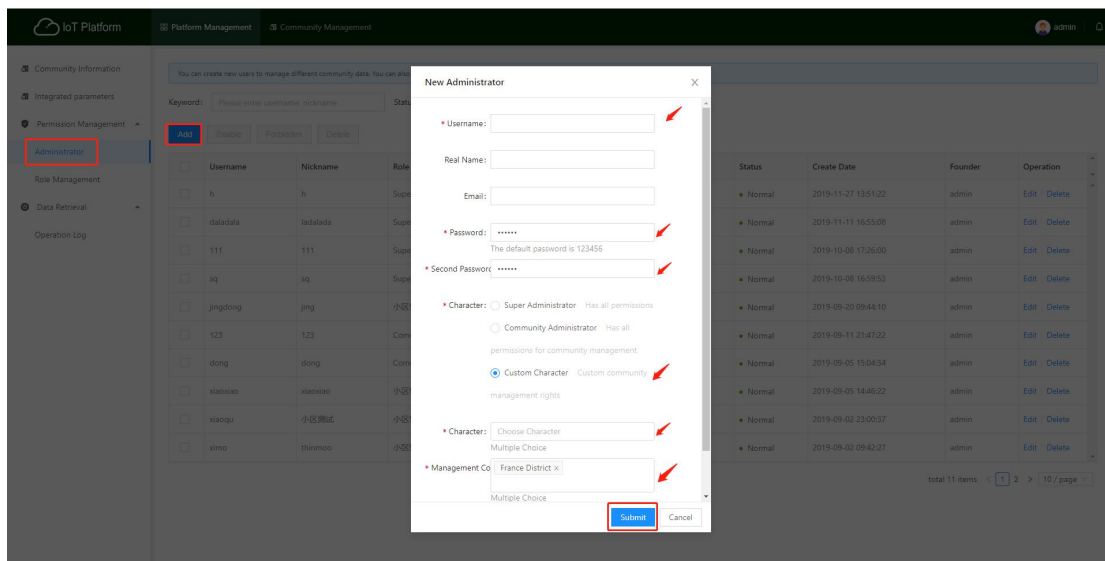

2.2.Role management

2.2.1 Add role management

Click [Add], fill in the role-related information, select the function permission to assign the function permission to the role, and click [Submit].

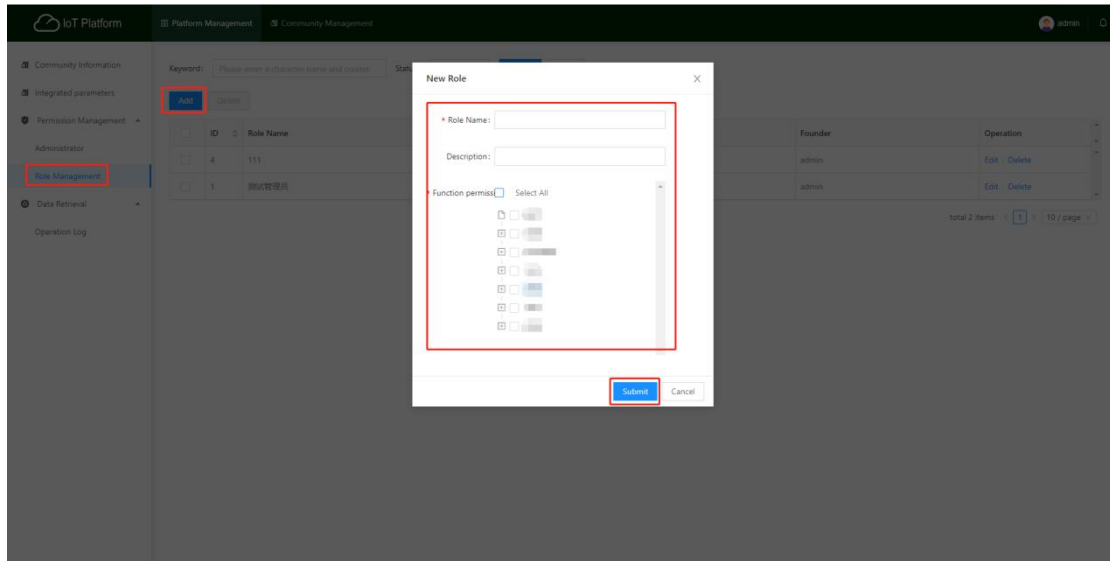

3. Community management

3.1 Add Community

Click the [Add] button, fill in the information about the new community, and click [Submit].

Description: The phone of the management office is used to transfer calls from Door device;

Whether to open the key application, used for whether the community can be selected when adding a room on the APP;

Whether to enable automatic face authentication, used for automatic authentication when adding faces to APP

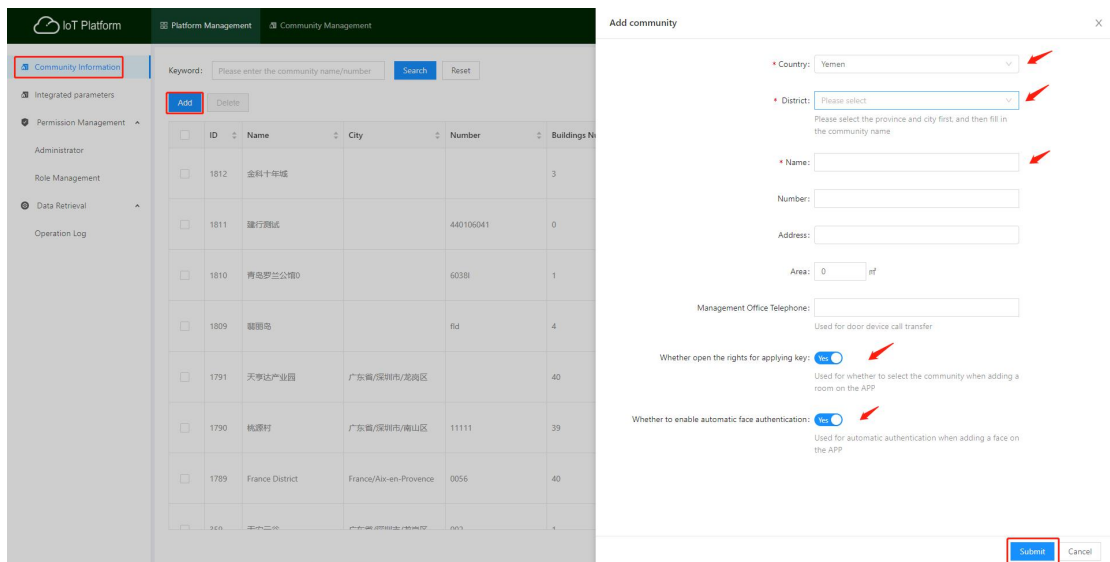

3.2 Community parameter configuration

List of community information, click the [community parameter configuration]

IoT Platform									
Platform Management Community Management									
Community Information									
Integrated parameters									
Permission Management									
Administrator									
Role Management									
Data Retrieval									
Operation Log									
Keyword: Please enter the community name/number									
Add Delete									
	ID	Name	City	Number	Buildings Number	Households Number	Device Number	Create Date	Operation
	1812	金科十年城			3	0	1	2020-01-04 16:17:04	Edit Delete Community Parameter Configuration Community Management
	1811	建行测试		440106041	0	0	2	2020-01-04 16:17:04	Edit Delete Community Parameter Configuration Community Management
	1810	青岛罗兰公寓0		6038	1	0	0	2020-01-04 16:17:04	Edit Delete Community Parameter Configuration Community Management
	1809	麒麟岛		81d	4	2	1	2020-01-04 01:27:35	Edit Delete Community Parameter Configuration Community Management
	1791	天孚达产业园	广东省/深圳市/龙岗区		40	669	0	2019-12-21 18:01:14	Edit Delete Community Parameter Configuration Community Management
	1790	桃源村	广东省/深圳市/南山区	11111	39	669	0	2019-12-20 18:26:04	Edit Delete Community Parameter Configuration Community Management
	1789	France District	France/Aix-en-Provence	0056	40	676	0	2019-12-20 18:21:51	Edit Delete Community Parameter Configuration Community Management
	1788	天孚达产业园	广东省/深圳市/龙岗区		40	669	0	2019-12-20 18:21:51	Edit Delete Community Parameter Configuration Community Management
total 20 items < 1 2 > 10 / page									

You can modify management office telephone, whether to open the application key and whether to enable automatic face authentication in [Basic Parameter Settings], and click [Save].

IoT Platform									
Platform Management Community Management									
Community Information									
Integrated parameters									
Permission Management									
Administrator									
Role Management									
Data Retrieval									
Operation Log									
Keyword: Please enter the community name/number									
Add Delete									
	ID	Name	City	Number	Buildings Number	Households Number	Device Number	Create Date	Operation
	1812	金科十年城			3	0	1	2020-01-04 16:17:04	Edit Delete Community Parameter Configuration Community Management
	1811	建行测试		440106041	0	0	2	2020-01-04 16:17:04	Edit Delete Community Parameter Configuration Community Management
	1810	青岛罗兰公寓0		6038	1	0	0	2020-01-04 16:17:04	Edit Delete Community Parameter Configuration Community Management
	1809	麒麟岛		81d	4	2	1	2020-01-04 01:27:35	Edit Delete Community Parameter Configuration Community Management
	1791	天孚达产业园	广东省/深圳市/龙岗区		40	669	0	2019-12-21 18:01:14	Edit Delete Community Parameter Configuration Community Management
	1790	桃源村	广东省/深圳市/南山区	11111	39	669	0	2019-12-20 18:26:04	Edit Delete Community Parameter Configuration Community Management
	1789	France District	France/Aix-en-Provence	0056	40	676	0	2019-12-20 18:21:51	Edit Delete Community Parameter Configuration Community Management
	1788	天孚达产业园	广东省/深圳市/龙岗区		40	669	0	2019-12-20 18:21:51	Edit Delete Community Parameter Configuration Community Management

Community Parameter Configuration

Basics Parameter Set

Card Parameter Setting

Device Parameter Setting

Management Office Telephone

Management office phone for VTO call management

Whether open the rights for

Used for whether to select the community when adding a room on the APP

Whether to enable automatic

Used for automatic authentication when adding a face on the APP

Save

The card sector and ladder-controlled sector can be used in [Card Parameter Setting] for offline card writing. Click [Save].

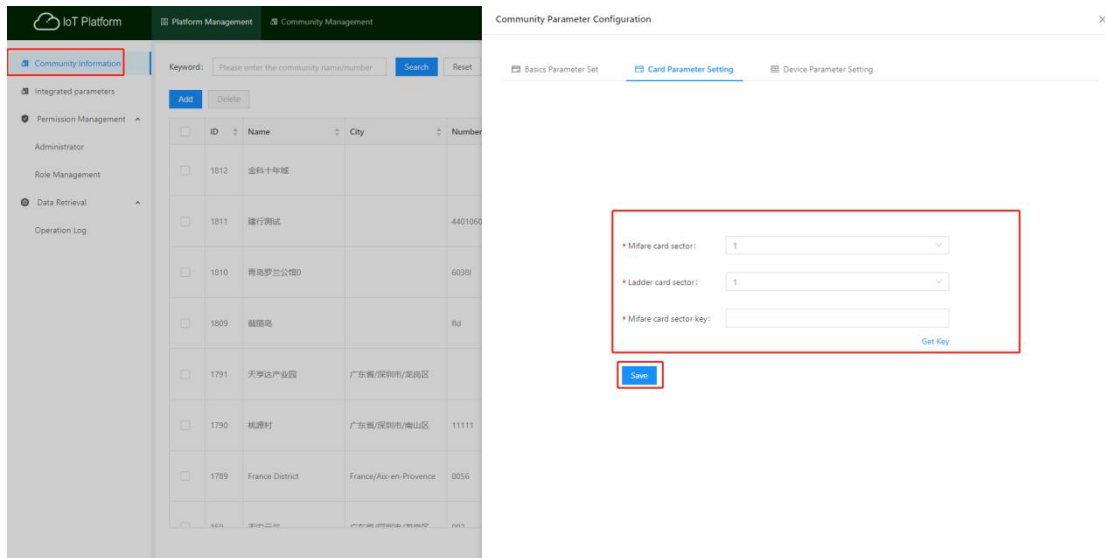

You can set it in [Device parameter setting], fill in and click [Save].

Description: The device management password is used for device access management settings; the emergency door opening password is used for emergency door opening of the device. Press *, then enter the emergency door opening password, and press # to confirm.

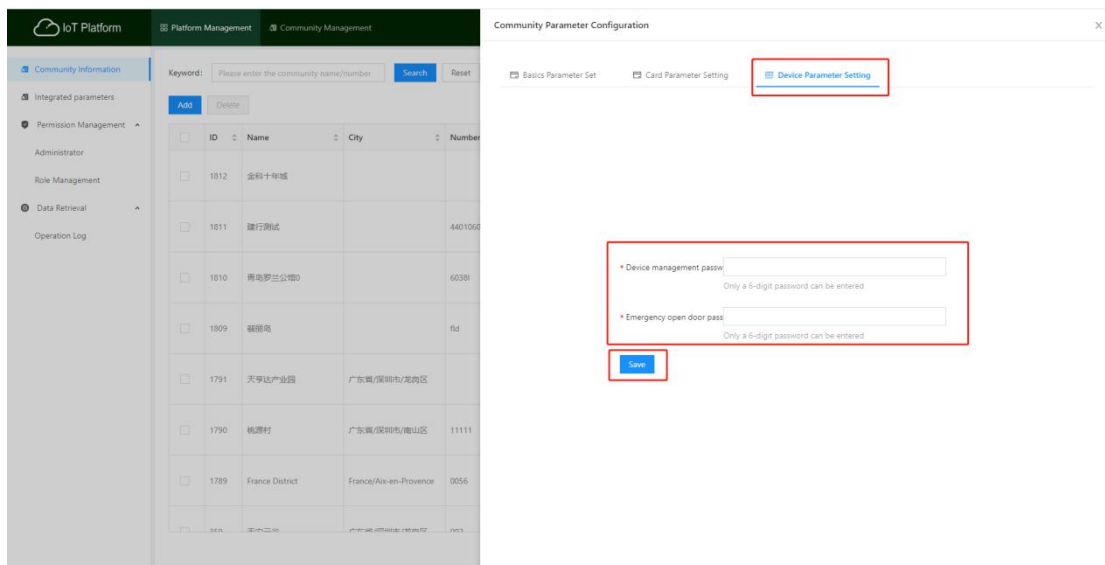

3.3 Switch community

On the [Community Management] page, click the community module to enter the community management page

Description: each community is managed independently

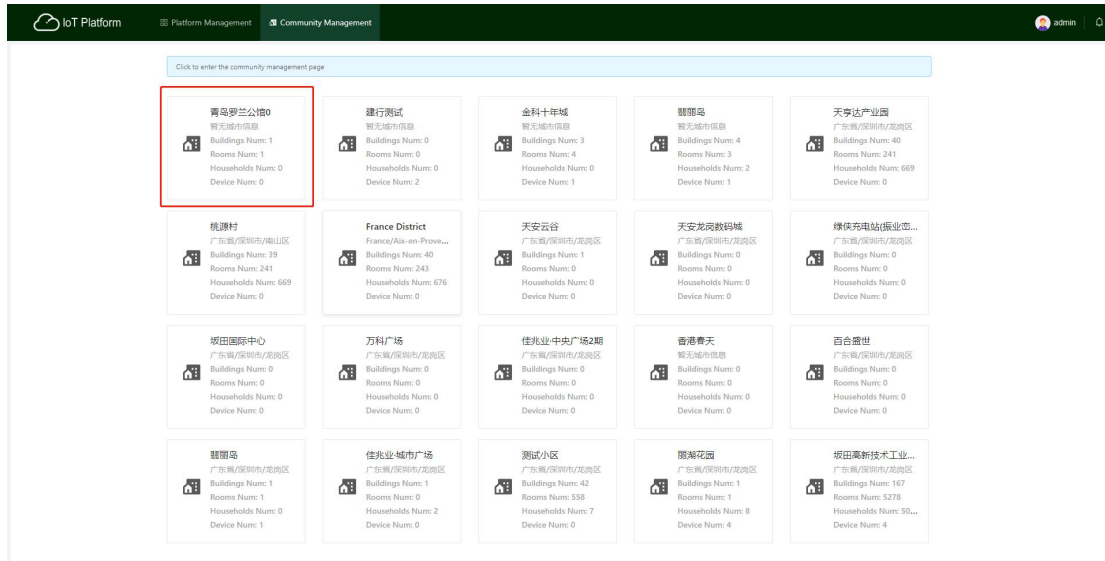

You can also click [Community Management] on the community list page

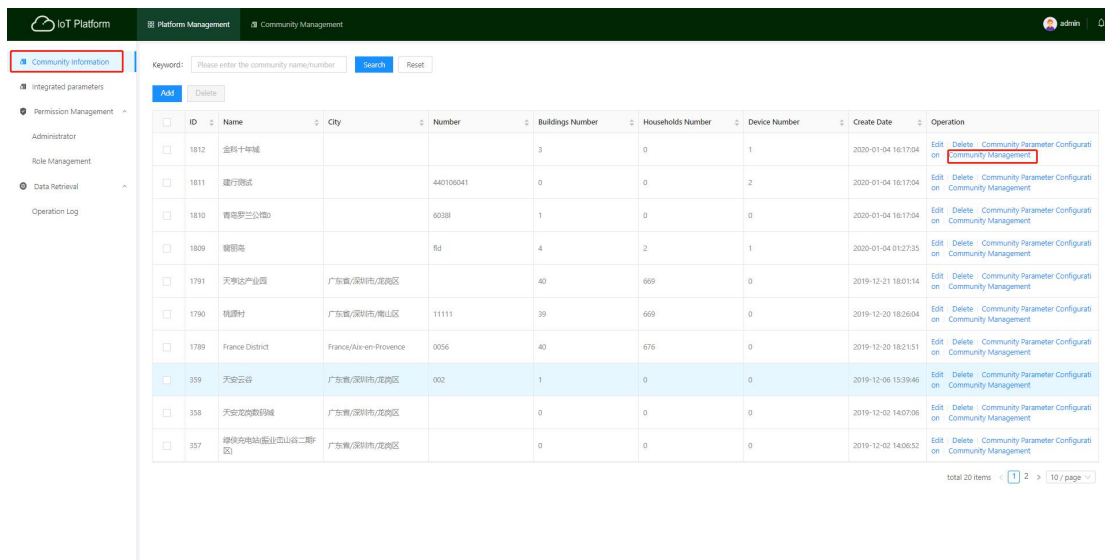

You can also click the current community and switch the community in the [Switch Management community] list

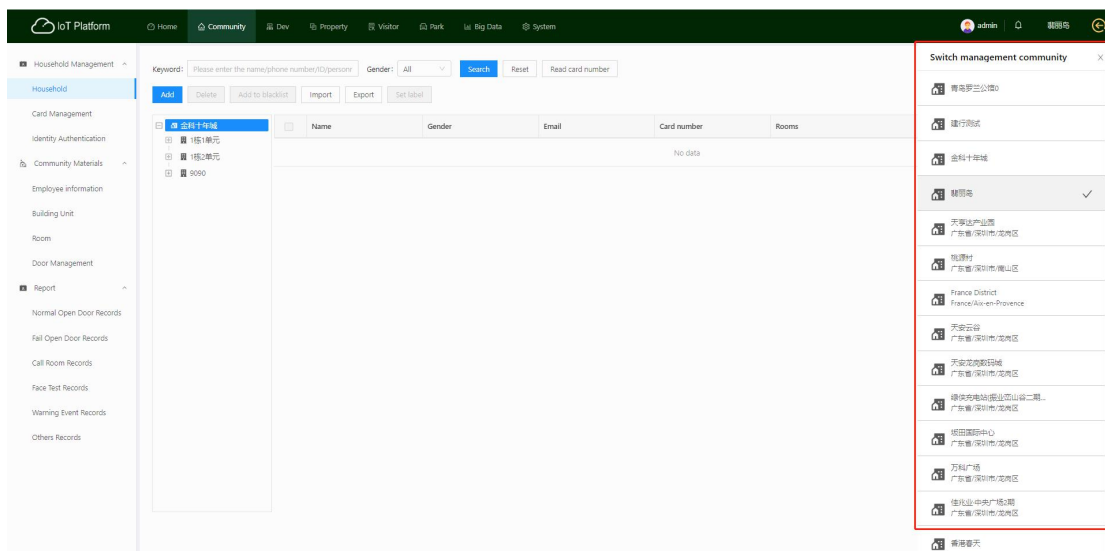

Click the [Back] button to return to the platform management page

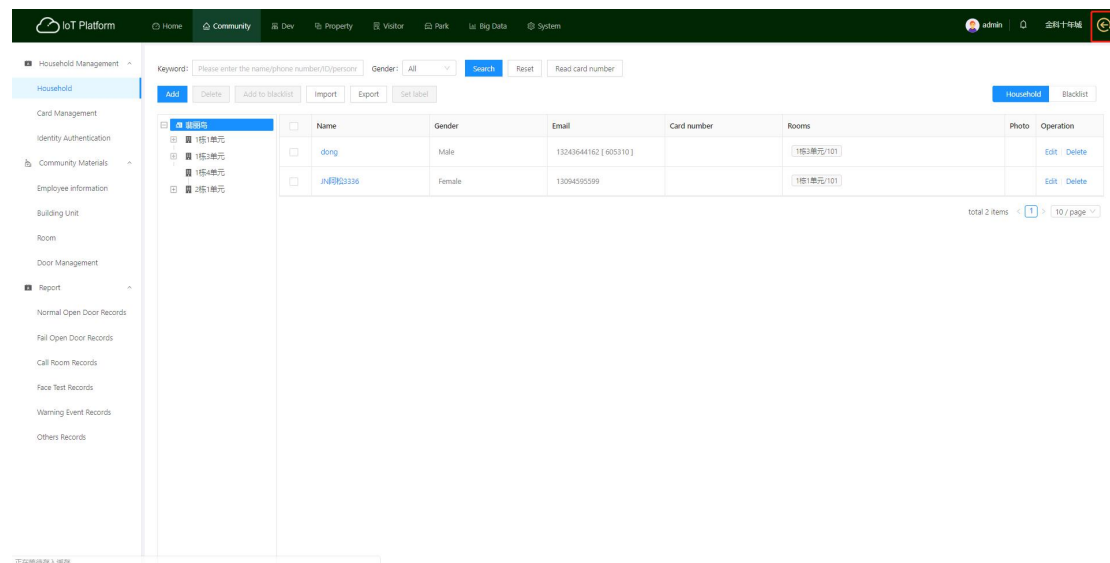

After switched community successfully, enter the current community management page.

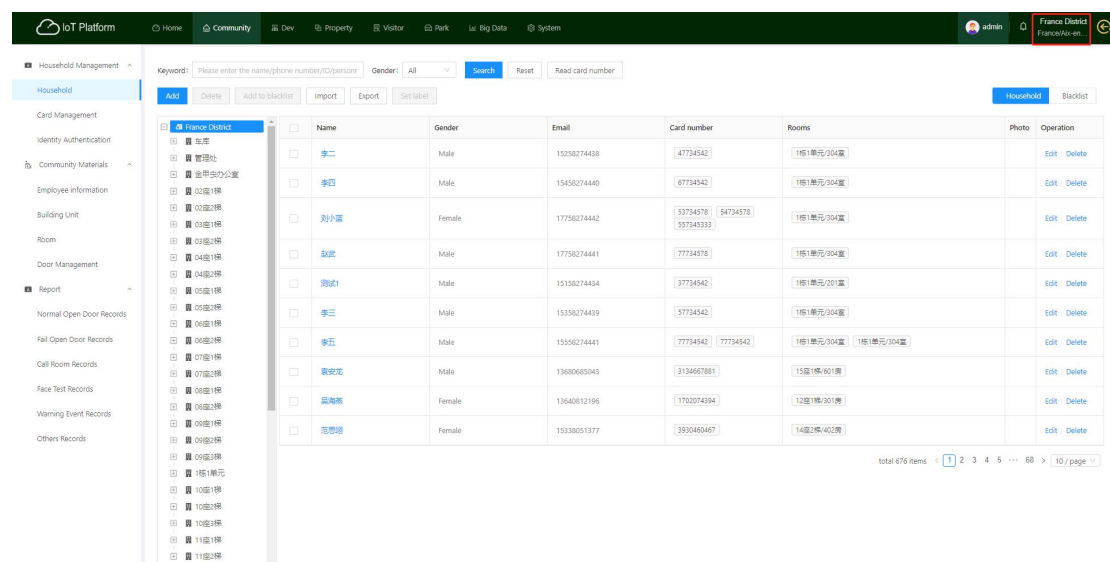

4. Building unit management

4.1 Building Unit

4.1.1 Add building units

Click the [Add] button to fill in the relevant information of the building unit. A door is added to the building by default. You can set the door name. Click the [Add Door] button to continue adding other doors. Finally, click [Submit].

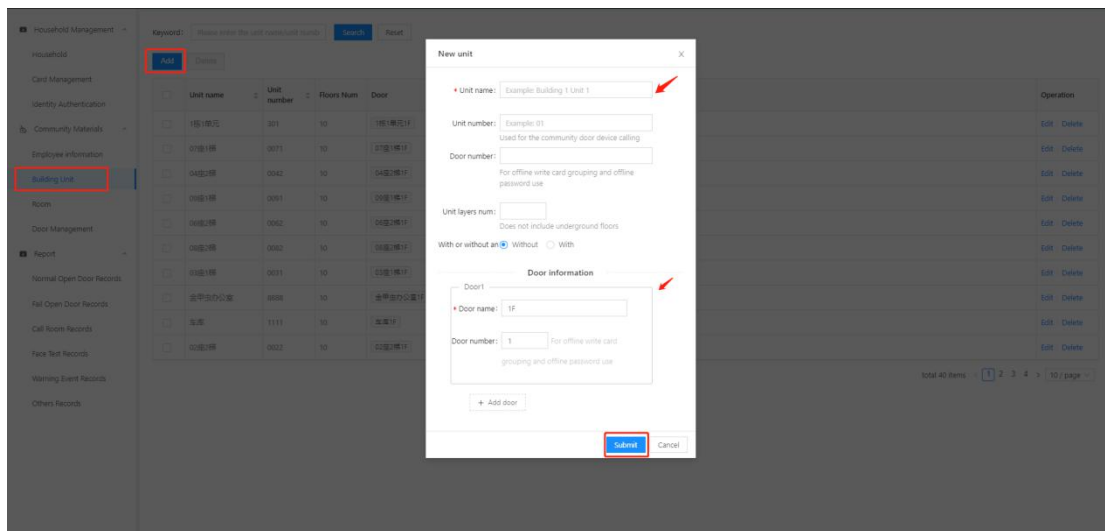

5. House management

5.1 House management

5.1.1 Add house management

Click the [Add] button to fill in the house related information. If using intercom, please fill in the house number and click [Submit].

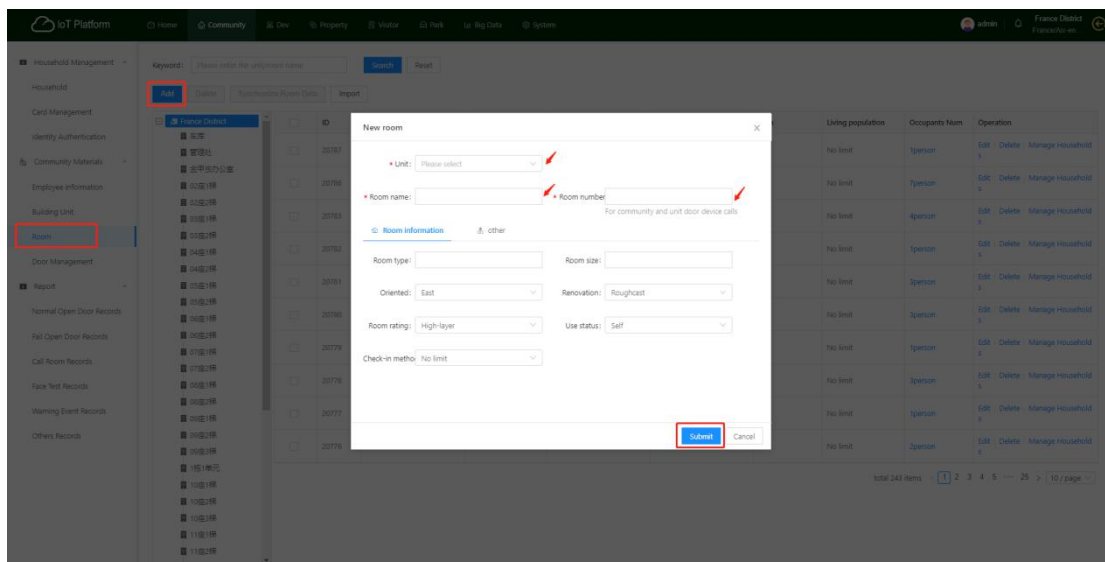

6. Door management

6.1 Door

Special Description: The door number is used for offline card writing and offline password to open the door. If using a networked device, ignore this parameter.

6.1.1 Add community gate

Click the [Add] button and fill in the relevant information of the door. [Installation location] can select [Community] to create the door, and click [Submit].

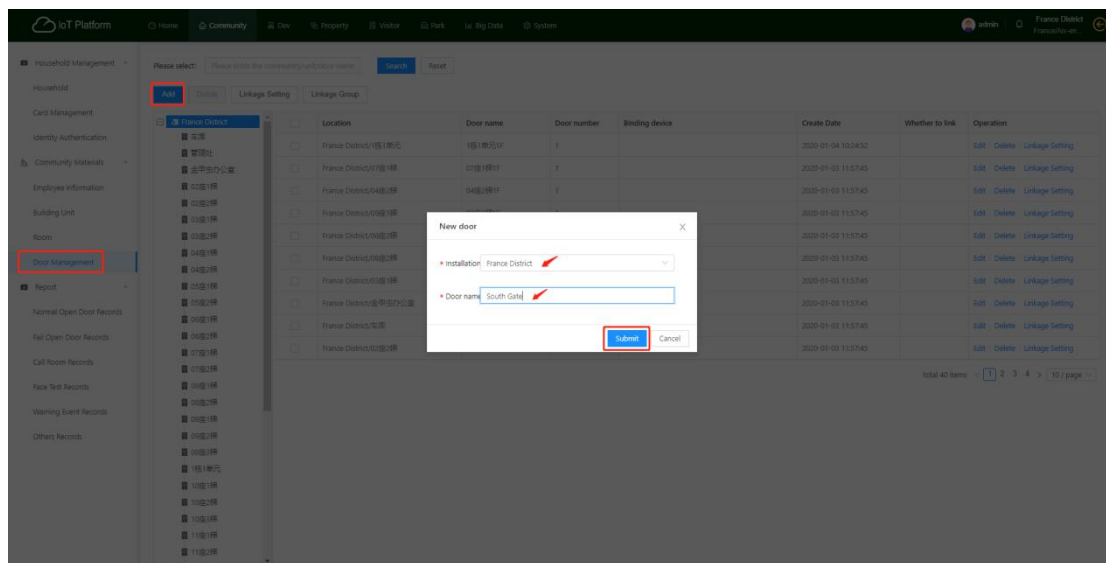

6.1.2 Add unit door

Click the [Add] button and fill in the relevant information of the door. [Installation location] can select [Building unit] to create the door, and click [Submit].

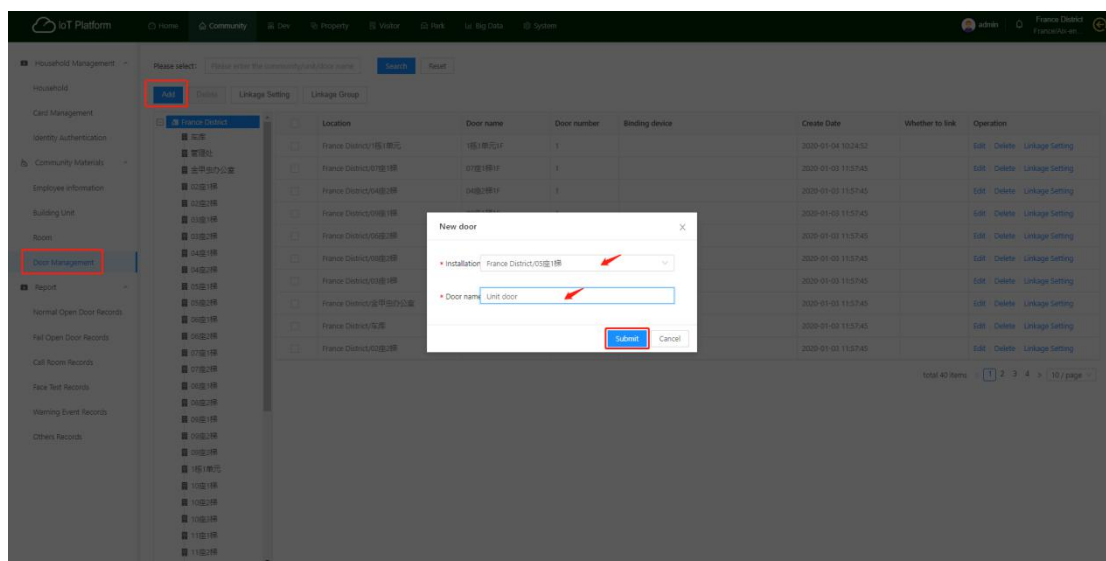

6.1.3 Add room door

Click the [Add] button and fill in the relevant information of the door. [Installation location] can select [Room] to create the door, and click [Submit].

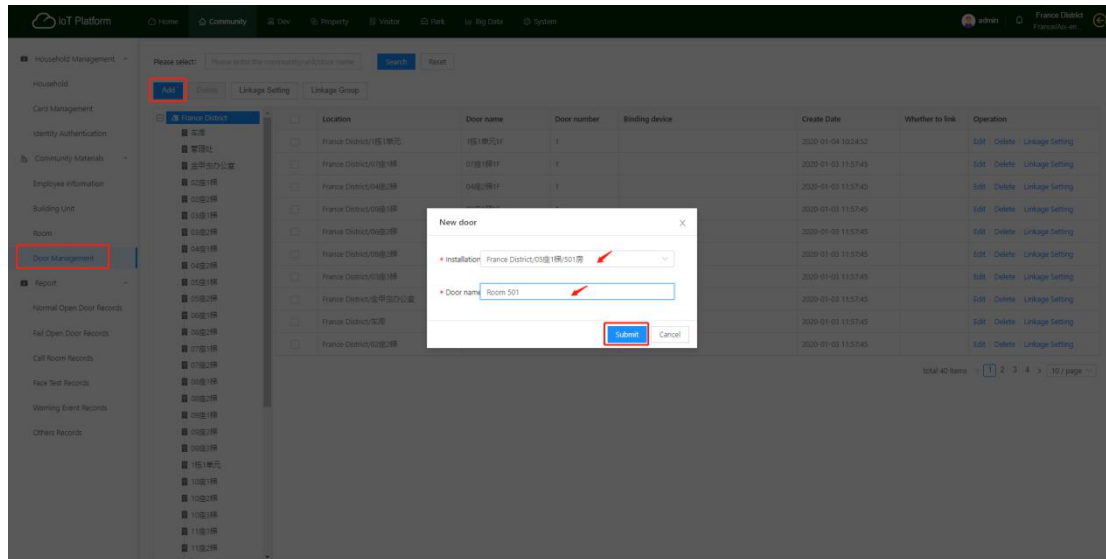

7. Community

7.1 Household Management

Special Description: Add the [Card Writer Read Card] button in the household card management for offline card writing. If you use a networked device, ignore this operation, please use the card reader to get the card number

1. Card reader instructions: Connect the card reader to the USB port on the computer, and then click the [Add Card Number] button on the page. Put the card on the card reader and the card number will be automatically read into the text box;
2. Instructions for using the card writer read card: Connect the card writer to the USB port on the computer, and install the card writer driver on the computer to run setup.exe. The card reader obtains the card number. Click [Read card] button, and then put the physical card on the card reader device, it will automatically get the card number into the input box;

7.1.1 Add households

Click [Add], fill in the relevant information of the household, and click [Submit].

Description: Capture a person's face and bind it to the user, after selecting the house and door that require access control, the user information, face, and card information will be sent to the corresponding access control device, and the door can be opened through the face recognition and card or APP. After

selecting the access control time, the user is only allowed to have access control rights in the selected time period, and the door cannot be opened outside the time period. If the house is assigned to the resident, the access control time of the house shall prevail.

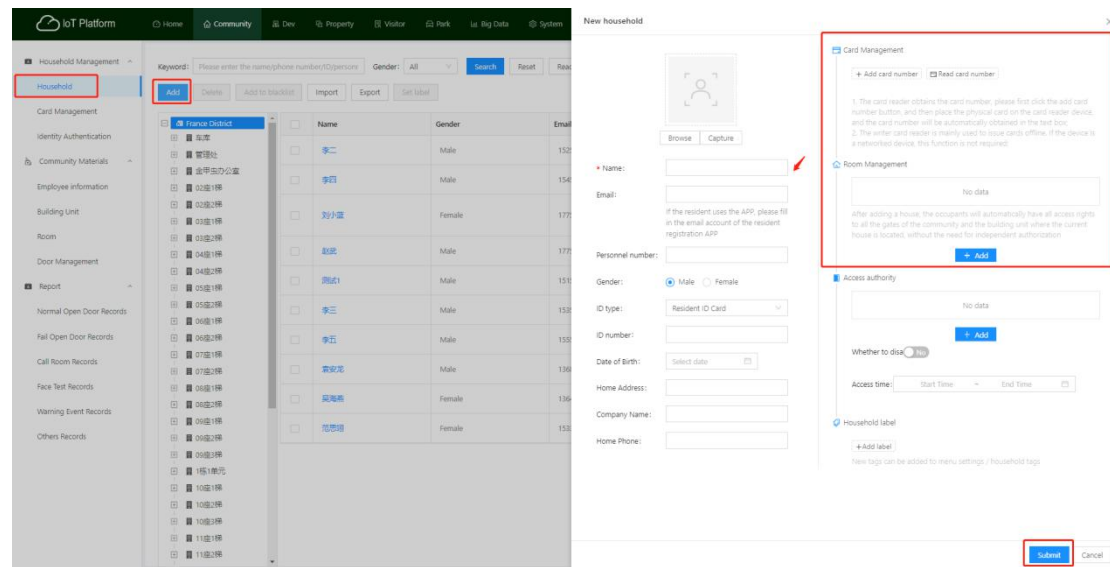

7.1.2 Offline card issue operation

1. Connect the card writer to the USB port on the computer and install the card writer driver on the computer to make setup.exe run
2. The card reader obtains the card number, please click the [Card Writer Read Card] button, and then place the physical card on the card reader device, and the card number will be automatically obtained in the input box;
3. Click [Add Card Number] to add multiple cards. Enter the text box manually or use a card reader to get the card number.

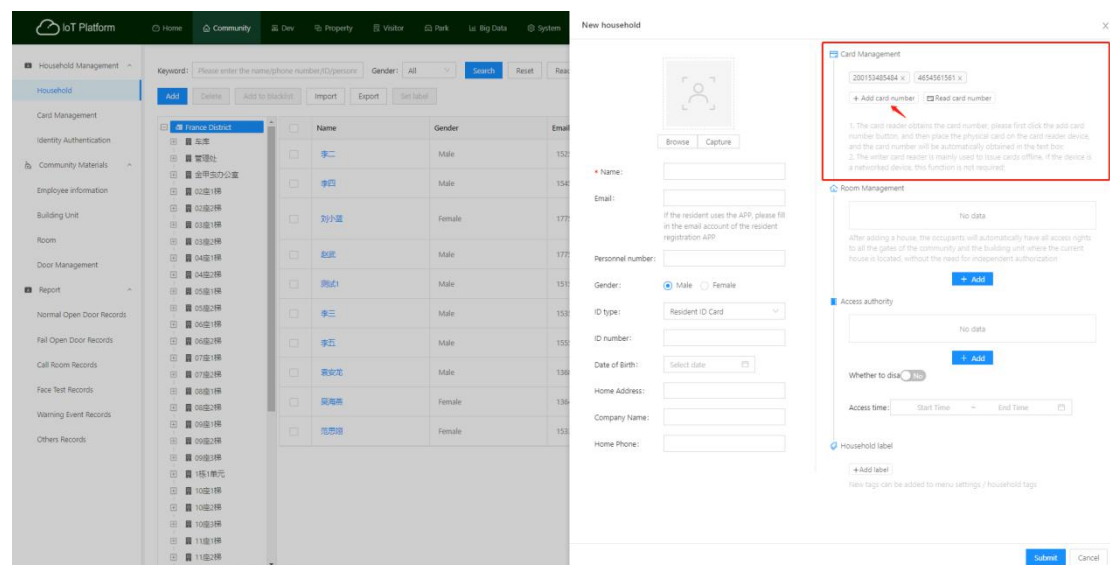

7.2 Card management

7.2.1 Card operation

- Release loss:** Check the card number and click [Release loss] to change the status of the lost card to normal. At this time, the card can open the door normally.
- Report Loss:** Check the card number and click [Report Loss] to change the normal card status to report loss. At this time, the card cannot open the door normally.
- Disable:** Check the card number and click [Disable] to change the normal card status to disabled. At this time, the card cannot open the door normally.
- Enable:** Check the card number and click [Enable] to change the status of the disabled card to enabled. At this time, the card can open the door normally.

IoT Platform

Home Community Dev Property Visitor Park Big Data System

admin France District France/Paris

Household Management

Household

Card Management

Identity Authentication

Community Materials

Employee information

Building Unit

Room

Door Management

Report

Normal Open Door Records

Fall Open Door Records

Call Room Records

Face Test Records

Warning Event Records

Others Records

Keyword: Please enter the name/APP account/ID Status: All Search Reset

Release loss Report loss Disable Enable

ID	Personnel name	Phone number	ID type	ID number	Card number	Status	Create Date
100132866	刘小强	17758274442		4360982384579	557345333	Normal	2020-01-04 10:24:52
100132865	刘小强	17758274442		4360982384579	54734578	Normal	2020-01-04 10:24:52
100132864	刘小强	17758274442		4360982384579	53734578	Normal	2020-01-04 10:24:52
100132863	刘小强	17758274441		4360982384577	77734578	Normal	2020-01-04 10:24:52
100132862	李四	15558274441		4360982384545	77734542	Normal	2020-01-04 10:24:52
100132861	李五	15558274441		4360982384545	77734542	Normal	2020-01-04 10:24:52
100132860	李四	15438274440		4350982384545	67734542	Normal	2020-01-04 10:24:52
100132859	李三	15358274439		4340982384545	57734542	Normal	2020-01-04 10:24:52
100132858	李二	15258274438		4330982384545	47734542	Normal	2020-01-04 10:24:52
100132857	张三	15158274434		4320982384546	37734542	Normal	2020-01-04 10:24:52

total 687 items 1 2 3 4 5 ... 69 10 / page

8. Device

8.1 Device management

8.1.1 Add device

Click the [Add] button, fill in the related device information, and click [Submit].

Description: It is not allowed to install two door devices on the same door (installation position). When adding a door device, the user information, user face, card, management device, indoor device, house, property, advertisement, announcement and visitors data will be added to the device.

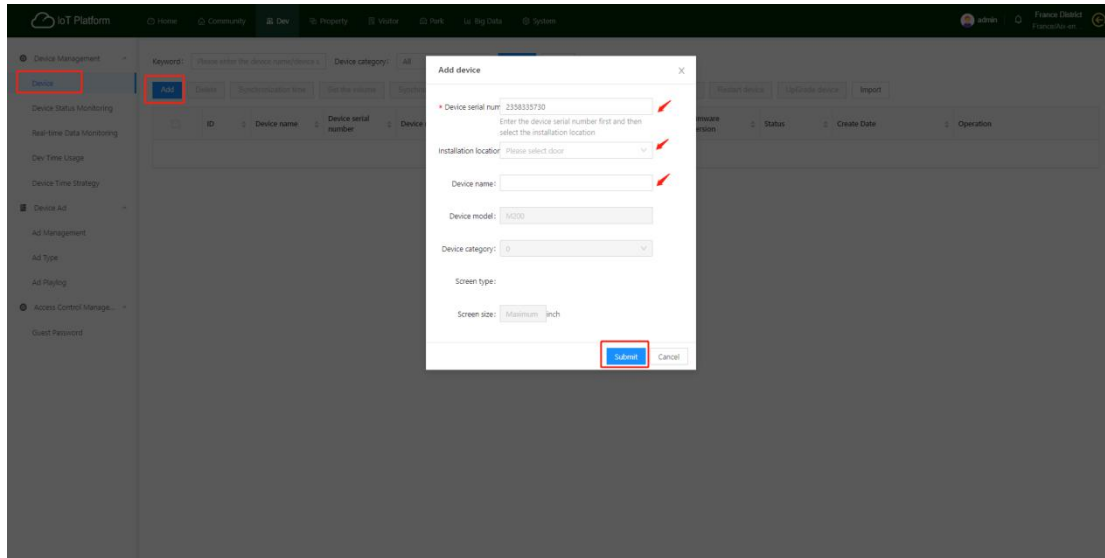

9.Visitors password

9.1 Visitors password

9.1.1 View visitors password

Support device serial number, creator, password type, expiration, etc.

Description: The visitors password is the visitor temporary door opening password created by the user on the APP. You can use the password or QR code to open the door on the corresponding device.

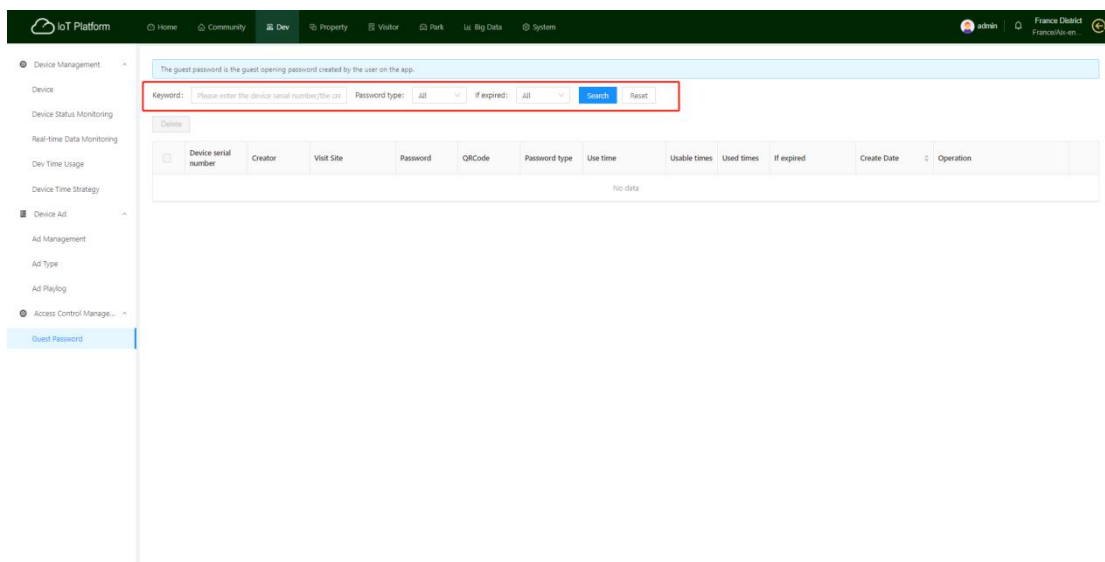

9.1.2 Edit visitor password

Click the [Edit] button, you can edit the visitor password related information in the pop-up box, and click [Submit].

Description: The visitor password is the visitor door password created by the user on the APP. You can use the password or QR code to open the door on the corresponding device.

The guest password is the guest opening password created by the user on the app.

Keywords: Please enter the device serial number/the QR Code Password type: All if expired: All

<input type="checkbox"/>	Device serial number	Creator	Visit Site	Password	QRCode	Password type	Use time	Usable times	Used times	If expired	Create Date	Operation
<input type="checkbox"/>	3645041785	陈亚伟		791458	69857420	在线密码	2019-12-31 11:20:00~2020-01-31 13:20:00	16	12	≠ No	2019-12-28 11:20:47	<input type="button" value="Edit"/> <input type="button" value="Delete"/>
<input type="checkbox"/>	4113604779	陈亚伟		791458	69857420	在线密码	2019-12-28 11:20:00~2019-12-28 13:20:00	16	0	≠ Yes	2019-12-28 11:20:47	<input type="button" value="Edit"/> <input type="button" value="Delete"/>
<input type="checkbox"/>	1949423733	陈亚伟		791458	69857420	在线密码	2019-12-28 11:20:00~2019-12-28 13:20:00	16	0	≠ Yes	2019-12-28 11:20:47	<input type="button" value="Edit"/> <input type="button" value="Delete"/>
<input type="checkbox"/>	1949406333	陈亚伟		791458	69857420	在线密码	2019-12-28 11:20:00~2019-12-28 13:20:00	16	0	≠ Yes	2019-12-28 11:20:47	<input type="button" value="Edit"/> <input type="button" value="Delete"/>
<input type="checkbox"/>	4113604779	陈亚伟	福田高新技术产业园(1栋1单元101)	721495	62817459	在线密码	2019-12-28 11:13:00~2019-12-28 13:13:00	1	0	≠ Yes	2019-12-28 11:14:13	<input type="button" value="Edit"/> <input type="button" value="Delete"/>
<input type="checkbox"/>	1949423733	陈亚伟	福田高新技术产业园(1栋1单元101)	721495	62817459	在线密码	2019-12-28 11:13:00~2019-12-28 13:13:00	1	0	≠ Yes	2019-12-28 11:14:13	<input type="button" value="Edit"/> <input type="button" value="Delete"/>
<input type="checkbox"/>	1949406333	陈亚伟	福田高新技术产业园(1栋1单元101)	721495	62817459	在线密码	2019-12-28 11:13:00~2019-12-28 13:13:00	1	0	≠ Yes	2019-12-28 11:14:13	<input type="button" value="Edit"/> <input type="button" value="Delete"/>
<input type="checkbox"/>	3645041785	陈亚伟	福田高新技术产业园(1栋1单元101)	189325	96753142	在线密码	2019-12-27 17:39:00~2020-01-31 19:39:00	8	6	≠ Yes	2019-12-27 17:42:45	<input type="button" value="Edit"/> <input type="button" value="Delete"/>
<input type="checkbox"/>	3760235577	陈亚伟	福田高新技术产业园(1栋1单元101)	189325	96753142	在线密码	2019-12-27 17:39:00~2020-01-31 19:39:00	29	26	≠ No	2019-12-27 17:42:45	<input type="button" value="Edit"/> <input type="button" value="Delete"/>
<input type="checkbox"/>	4113604779	陈亚伟	福田高新技术产业园(1栋1单元101)	189325	96753142	在线密码	2019-12-27 17:39:00~2020-01-31 19:39:00	8	0	≠ Yes	2019-12-27 17:42:45	<input type="button" value="Edit"/> <input type="button" value="Delete"/>

total 24 items 2 3 > 10 / page

10. Call intercom

10.1 Access control community indoor unit

10.1.1 Door device call intercom

Operation process description: New community -> building -> new room-> new household <-> new device

Calling process description: Press room number on door device (house number -> press # to confirm -> indoor device reception-(not connected)-> transfer calling APP-(not connected)-> transfer dial [Calling Forwarding Number] set in [Other] in [Add House];

Step 1: Add community

Country:

District:

Name:

Number:

Address:

Area: of

Management Office Telephone:

Whether open the rights for applying key: ☒ Yes

Whether to enable automatic face authentication: ☒ Yes

Step 2: Add building Unit

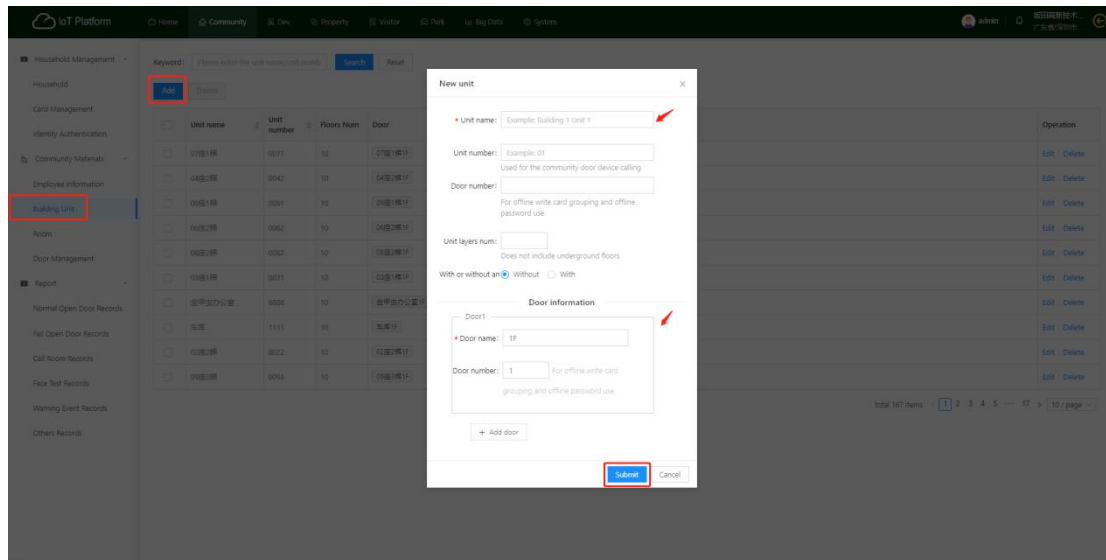

Step 3: Add a new room. Note that the calling forwarding number is used to fill the door device call.

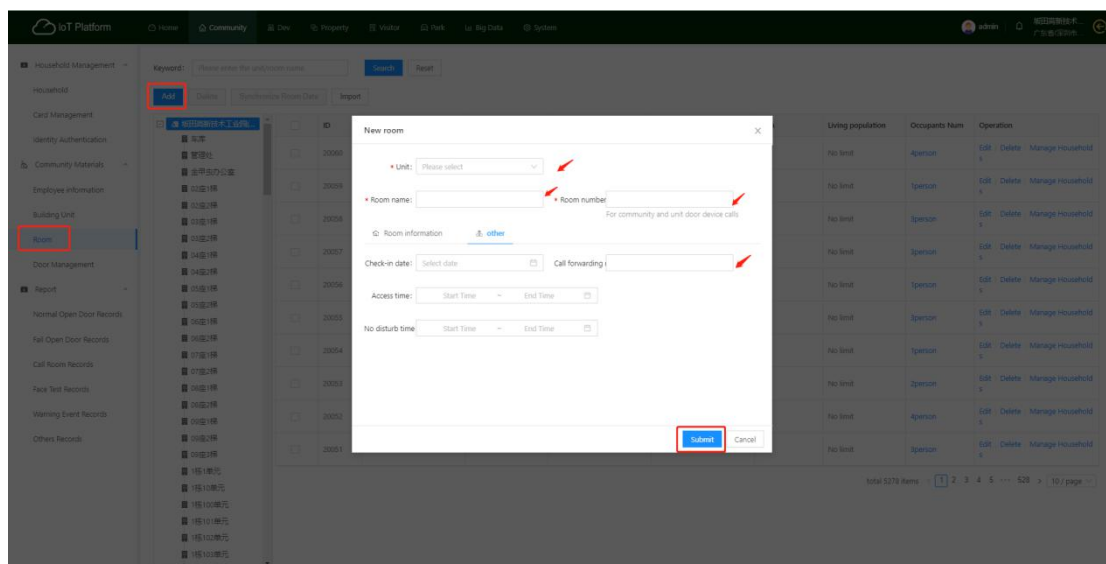

Step 4: Add a new household. If all the household in this room have a mobile account registered with the APP, the door device calling will be used.

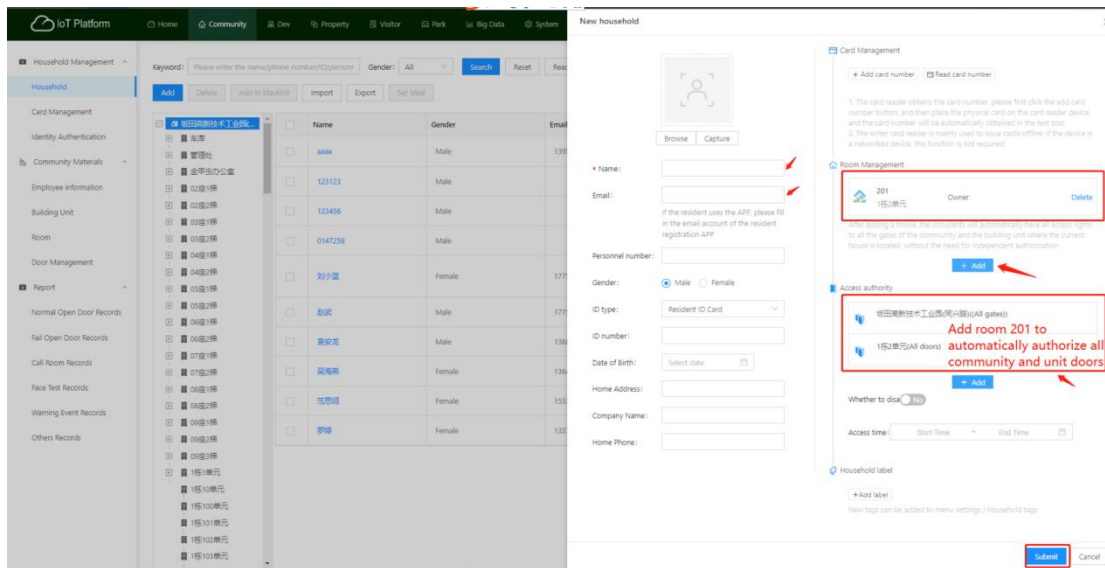

Step 5: Add device

Description: Add new device and bind the installation location (eg: add [community door device] binding location to select a community; add [indoor device] binding location to select a community / building / room)

Description: If the intercom data is not saved successfully, you can click the [Device]-> [Synchronize All Data] button and select [Intercom Data] to synchronize the intercom data. This is used to add the intercom data to the device after the device is submitted.

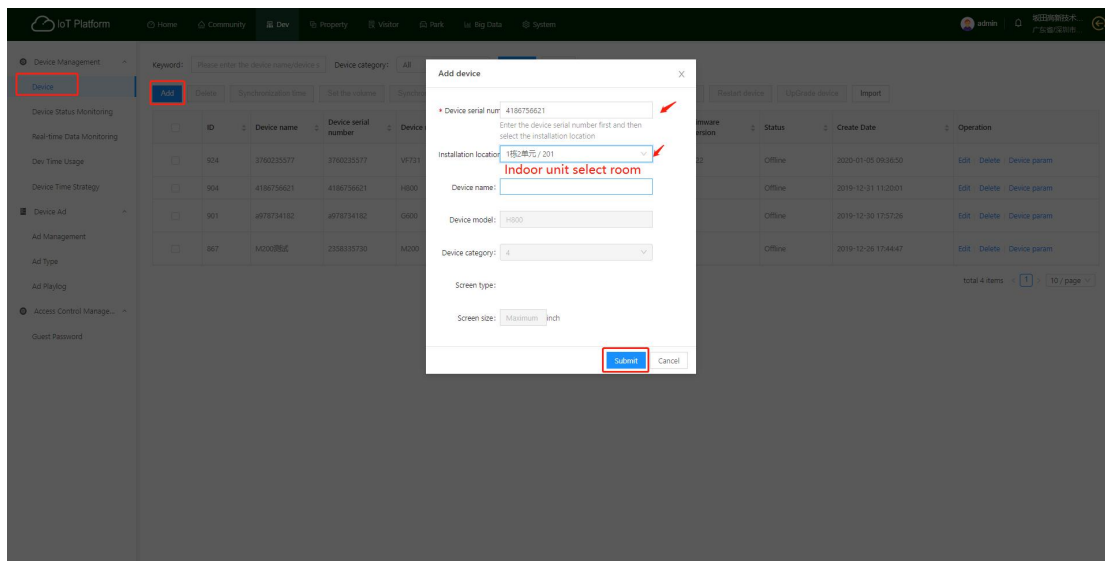

If testing door device call indoor device, you can add the door device to test, such as:

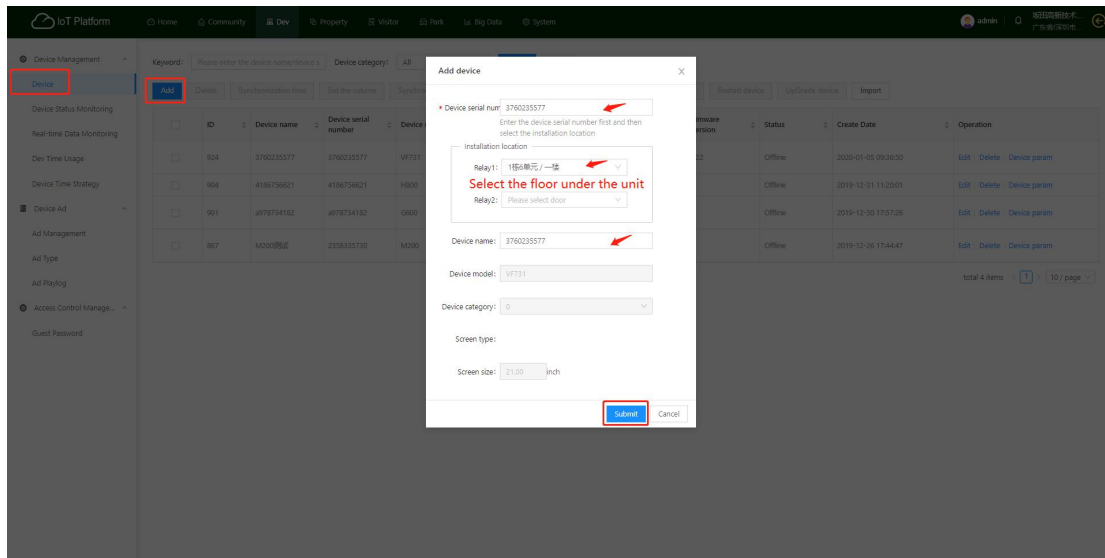

Finally, enter the unit number on the door device, and then enter the room number, you can dial the door device (or choose the device name on the indoor device to call the door device).

If connected (call the indoor device first, (not connected), then transfer the APP, (missed), and finally transfer the [call forwarding number] set in the room).

Third-party access control device integration flowchart (non-integrated, can be ignored)

